

# THE GOOD UNIVERSITIES GUIDE 2020

## ARCHITECTURE & BUILDING

This is a detailed profile of the architecture and building field of study. It lists the range of specialisations available and compares degree-level courses. We examine the institutions that get the best ratings, based on real student experience and graduate outcome data, which will help you decide the right university for your educational journey.



# ARCHITECTURE & BUILDING

Architecture is one of the most influential professions in society. It is a fascinating field that blends art, culture, science, technology and even elements of business, with its skilled professionals at the centre of Australia's \$100 billion built environment industry.

## FULL-TIME EMPLOYMENT

**UNDERGRADUATE** **POSTGRADUATE**

Proportion of students who have secured a full-time job within four months of graduating.

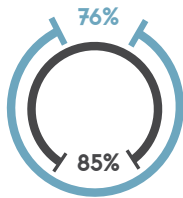

## MEDIAN GRADUATE SALARY

**\$56,600**

**UNDERGRADUATE**

**\$60,000**

**POSTGRADUATE**

## NUMBER OF STUDENTS



**4,921**  
**UNDERGRADUATE**  
**INTERNATIONAL**

**24,116**  
**UNDERGRADUATE**

**9,878**  
**POSTGRADUATE**

## WHAT CAN I DO?



Surveying



Production Design



Town Planning



Structural Engineering



Interior Design

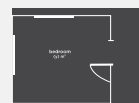

Architecture

Data has been sourced from the Graduate Outcomes Survey. Results are pooled to represent graduates who completed the survey in 2018, 2017 and 2016. Graduates complete the Graduate Outcomes Survey approximately four months post-graduation.



# FIVE-STAR UNIVERSITIES

## ARCHITECTURE & BUILDING

EDUCATIONAL EXPERIENCE	GRADUATE EMPLOYMENT	LEARNER ENGAGEMENT	LEARNING RESOURCES
SUNSHINE COAST 89.3%	CQUni 93.9%	BOND 77.8%	BOND 92.1%
CQUni 88.5%	UNE 91.8%	QUEENSLAND 75.7%	MACQUARIE 88.7%
UNE 85.9%	NEWCASTLE 91.6%	CURTIN 75.6%	UniSA 86.6%
BOND 85.2%	WESTERN SYDNEY 84.8%	MONASH 74.5%	WESTERN SYDNEY 86.4%
UniSA 82.0%	UNSW 84.6%	GRIFFITH 74.1%	NEWCASTLE 85.9%
NEWCASTLE 82.0%		UniSA 73.5%	
<b>NATIONAL AVERAGE = 75.5%</b>	<b>NATIONAL AVERAGE = 76.0%</b>	<b>NATIONAL AVERAGE = 67.2%</b>	<b>NATIONAL AVERAGE = 75.5%</b>
MEDIAN STARTING SALARY	SKILLS DEVELOPMENT	STUDENT SUPPORT	TEACHING QUALITY
CQUni \$80,000	BOND 84.8%	BOND 81.6%	UNE 88.9%
NEWCASTLE \$70,000	RMIT 83.7%	CQUni 78.9%	SUNSHINE COAST 88.9%
WESTERN SYDNEY \$66,300	QUEENSLAND 83.5%	GRIFFITH 77.6%	NEWCASTLE 84.7%
UNE \$62,600	MONASH 82.8%	CURTIN 76.1%	CANBERRA 84.1%
	UniSA 81.6%	DEAKIN 75.2%	BOND 83.3%
	CURTIN 81.5%		QUT 83.0%
	SUNSHINE COAST 81.5%		CQUni 82.7%
			UniSA 82.5%
<b>NATIONAL AVERAGE = \$56,600</b>	<b>NATIONAL AVERAGE = 79.5%</b>	<b>NATIONAL AVERAGE = 67.7%</b>	<b>NATIONAL AVERAGE = 78.6%</b>

**WHAT DO THESE NUMBERS MEAN?** The ratings above represent the top 20 per cent of results for each measure in this particular field of study. For overall institution results, see the ratings section at the front of the guide.

# ARCHITECTURE

Architecture is one of the most influential professions in society. It is a fascinating field that blends art, culture, science, technology and even elements of business, with its skilled professionals at the centre of Australia's \$100 billion built environment industry.

Architects work with building contractors, engineers, tradespeople, lawyers, accountants and just about anyone involved in delivering a building project. As well as taking care of the design process, they play an important advisory role for their clients.

If designing and creating appeal to you, you could also look at fields such as built environment, environmental studies, humanities and social sciences, creative arts and some engineering specialisations.

There are two types of architecture degrees in Australia: a five-year version and a two-part version that begins with an undergraduate 'pre-professional qualification' in architecture, arts, applied science, design or environmental design with an architecture major, followed by a two- or three-year specialist qualification in architecture.

Both qualifications must be followed by two years of practical experience and a further exam before you can register to practise. Whichever route you choose, you will study everything from engineering, structural design, building and project management to graphics and design. If you'd like to study even more widely, it's worth considering a double degree — you could combine architecture with construction, landscape architecture, engineering or even law.

As is common in courses leading into a profession, core units tend to predominate in architecture courses, although there may be some room for electives or specialisations. Apart from the usual lectures and tutorials, you can expect to spend plenty of time in the design studio and on practical assignments off campus. Most architecture courses require at least some competence in mathematics, and most allow full-time study only.

For more information, visit:

- Australian Institute of Architects (AIA)  
[www.architecture.com.au](http://www.architecture.com.au)
- Architects Accreditation Council of Australia  
[www.aaca.org.au](http://www.aaca.org.au)

## BUILT ENVIRONMENT

The following are just some of the majors you can study in this field:

The term 'built environment' refers to everything that is man-made, as opposed to a part of the natural environment. This includes the objects inside our homes and businesses, as well as our buildings, communities and cities. Built environment is a multidisciplinary field, meaning that it covers a range of diverse disciplines that can be found in different faculties or schools at universities. Specialisations differ considerably in the approach they take to the constructed environment. Some are concerned with building it, others with its sale, management or maintenance. Some consider how to sustain it, while others focus on its creation.

Courses are divided roughly into four sub-fields: design, construction, planning and property. Design degrees include industrial and interior design and landscape architecture, all of which lead into specific occupations. Degrees in planning (whether town planning, regional planning or urban planning) also lead into a distinct profession concerned with the big picture — how our towns and cities are developed.

For more information, visit:

- Australian Institute of Landscape Architects  
[www.aila.org.au](http://www.aila.org.au)
- Australian Institute of Building  
[www.aib.org.au](http://www.aib.org.au)
- Design Institute of Australia  
[www.design.org.au](http://www.design.org.au)
- Planning Institute of Australia  
[www.planning.org.au](http://www.planning.org.au)
- Urban Development Institute of Australia  
[www.udia.com.au](http://www.udia.com.au)

## WHERE TO STUDY

There are several things to consider when you're shopping around for an architecture and building course. The first is whether you can get in, as this is a competitive field. Getting into these courses has become more challenging in recent years. Prerequisites often include English, mathematics and — for design-based courses — art and design. Other subjects may be required or recommended depending on the niche you choose.